



National
Packaging Machinery

Strapping & Consumables

March 2025



PET Strapping

Polyester strapping can be tensioned to a higher percentage of its break strength than any other strapping material. It provides superior retained tension under hot, humid conditions and is more resistant to such environments than other plastic strapping. It also provides greater load stability during storage and shipping. Our strap is strong, yet resilient enough to perform smoothly and reliably in power strapping machines and hand tools. And it's more tear and snag resistant than other plastic strapping.



PETH-92065406
PET Green Strapping
Embossed
9.2mm x 0.65mm x 3000m
Core: 406mm
220kg ±10%



PETH-127020406
PET Green Strapping
12mm x 0.70mm x 2000m
Core: 406mm
Break Strain: 300kg ±10%



PETH-155101100EX
PET Green Strapping
Embossed Ex
15.5mm x 1.0mm x 1100m
Core: 406mm
Break Strain: 675kg ±10%



PETH-155101220
PET Green Strapping
Embossed
15.5 x 1.0mm x 1220m
Core: 406mm
Break Strain: 570kg ±10%



PETH-1901090406
PET Green Strapping
Embossed
18.5mm x 1.0mm x 900m
Core: 406mm
Break Strain: 630kg ±10%



PETH-1901095406SM
PET Green Strapping
Smooth
18.5mm x 1.0mm x 950m
Core: 406mm
Break Strain: 780kg ±10%

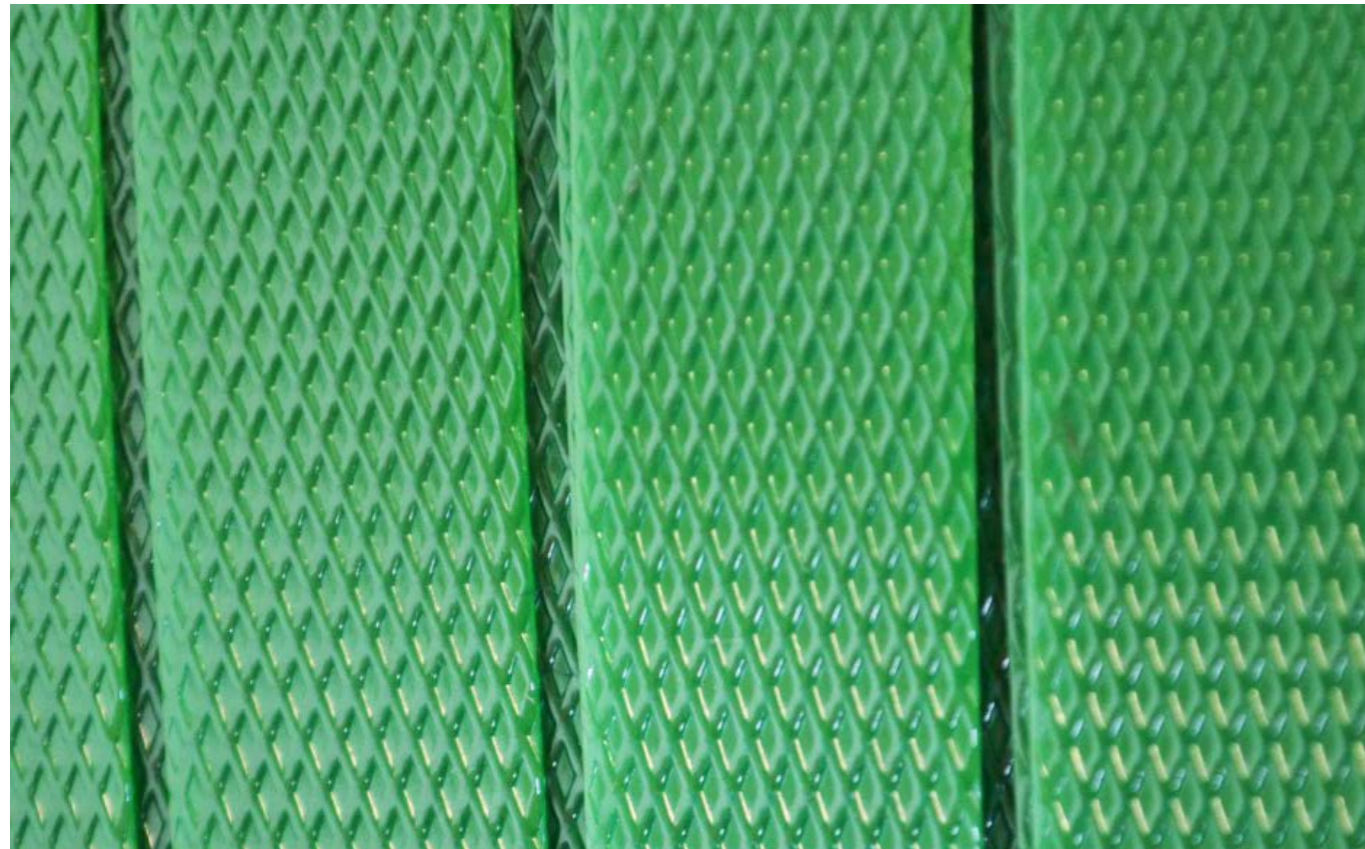

PP Strapping

Stringent Japanese Quality Control System with exceptional tensile strength and banding. Fully Auto Machine Strap: Used with fully or semi-automatic strapping machines. Hand Straps comes in a handy dispenser box. Easy to use and tension by hand. Can be sealed with poly buckles, wire buckles or metal seals.



PPH-5047WH
PP White Strapping
5mm x 0.47mm x 7000m
Core: 200mm
Break Strain: 60kg ±10%



PPH-9060CLR
PP Clear Strapping
9mm x 0.60mm x 4000m
Core: 200mm
Break Strain: 100kg ±10%



PPH-12060BLU
PP Blue Strapping
12mm x 0.60mm x 3000m
Core: 200mm
Break Strain: 140kg ±10%



PPH-12060CLR
PP Clear Strapping
12mm x 0.60mm x 3000m
Core: 200mm
Break Strain: 140kg ±10%



PPH-12065BLU
PP Blue Strapping
12mm x 0.65mm x 3000m
Core: 200mm
Break Strain: 140kg ±10%



PPH-12065CLR
PP Clear Strapping
12mm x 0.65mm x 3000m
Core: 200mm
Break Strain: 140kg ±10%



PPH-12065406BLK
PP Black Strapping
12mm x 0.65mm x 3000m
Core: 406mm
Break Strain: 140kg ±10%



PPH-12075406BLK
PP Black Strapping
12mm x 0.75mm x 2000m
Core: 406mm
Break Strain: 300kg ±10%



PPH-19070150BLK
Heavy Duty PP Black Strapping
19mm x 0.70mm x 1000m
Core: 150mm



PPH-19070406BLK
Heavy Duty PP Black Strapping
19mm x 0.70mm x 2000m
Core: 406mm



Other sizes are available upon request to suit your machine requirements minimum quantity orders may apply

PP Strapping Buckles & Seals

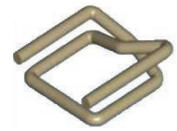

WB-LD-12
Wire Buckle Light Duty

Ø2.5 x 12mm
1000 / Box

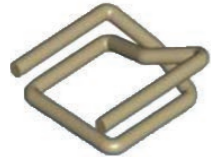

WB-LD-19
Wire Buckle Light Duty

Ø2.5 x 19mm
1000 / Box

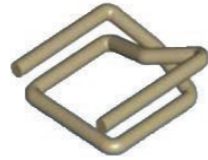

WB-HD-19
Wire Buckle Heavy Duty

Ø3.2 x 19mm
1000 / Box



MS-LD-12
Metal Seal Light Duty

0.5 x 12mm
1000 / Box

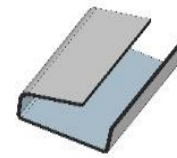

MS-LD-19
Metal Seal Light Duty

0.5 x 19mm
1000 / Box



MS-HD-16
Metal Seal Heavy Duty

0.6 x 16mm
1000 / Box

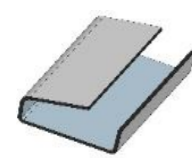

MS-HD-19
Metal Seal Heavy Duty

0.6 x 19mm
1000 / Box

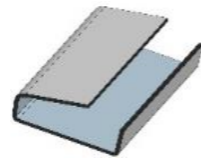

MS-EHD-19
Metal Seal Extra Heavy Duty

0.8 x 19mm
1000 / Box



SO-12
Snap on Seal

0.6 x 12mm
1000 / Box

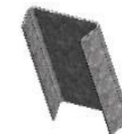

SO-16
Snap on Seal

0.6 x 16mm
1000 / Box

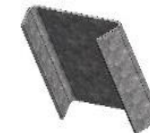

SO-19
Snap on Seal

0.6 x 19mm
1000 / Box

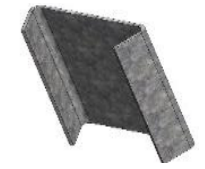

SO-32
Snap on Seal

0.8 x 32mm
250 / Box

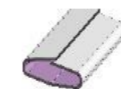

TOP16x22
Thread On Pusher Seal

16 x 22 x 0.8mm
1000 / Box

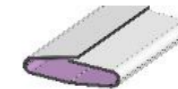

TOP19x26
Thread On Pusher Seal

19 x 26 x 0.8mm
1000 / Box

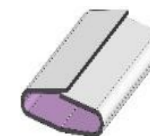

TOP19x44
Thread On Pusher Seal

19 x 44 x 0.8mm
500 / Box

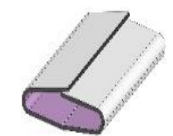

TOP19x58
Thread On Pusher Seal

19 x 58 x 0.8mm
500 / Box

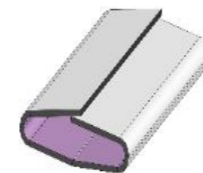

TOP-32x58
Thread On Pusher Seal

32 x 58 x 0.8mm
250 / Box





National
Packaging Machinery

Version 1.0

0800 766 662 www.pglgroup.co.nz
100% New Zealand Owned & Operated

